

# 70,000 ACRE BLOCK – ALLEN PH., LA YEGUA, WILCOX, AND CRETACEOUS POTENTIAL

*All deep rights available - attractive and flexible lease terms offered*

Located on and south of the Cretaceous shelf edge, where turbidities of Tuscaloosa age could be deposited seaward of the shelf edge, similar to fields in southeastern Louisiana. Fracturing of the Tuscaloosa Marine Shale may also be prevalent on the Sligo shelf.

Numerous 2D lines traversing the acreage are available for review on a Kingdom work station in our Houston office. These lines show a large regional unconformity.

Rollover features associated with faulting are also present at depth in the central and southern portion of the block.

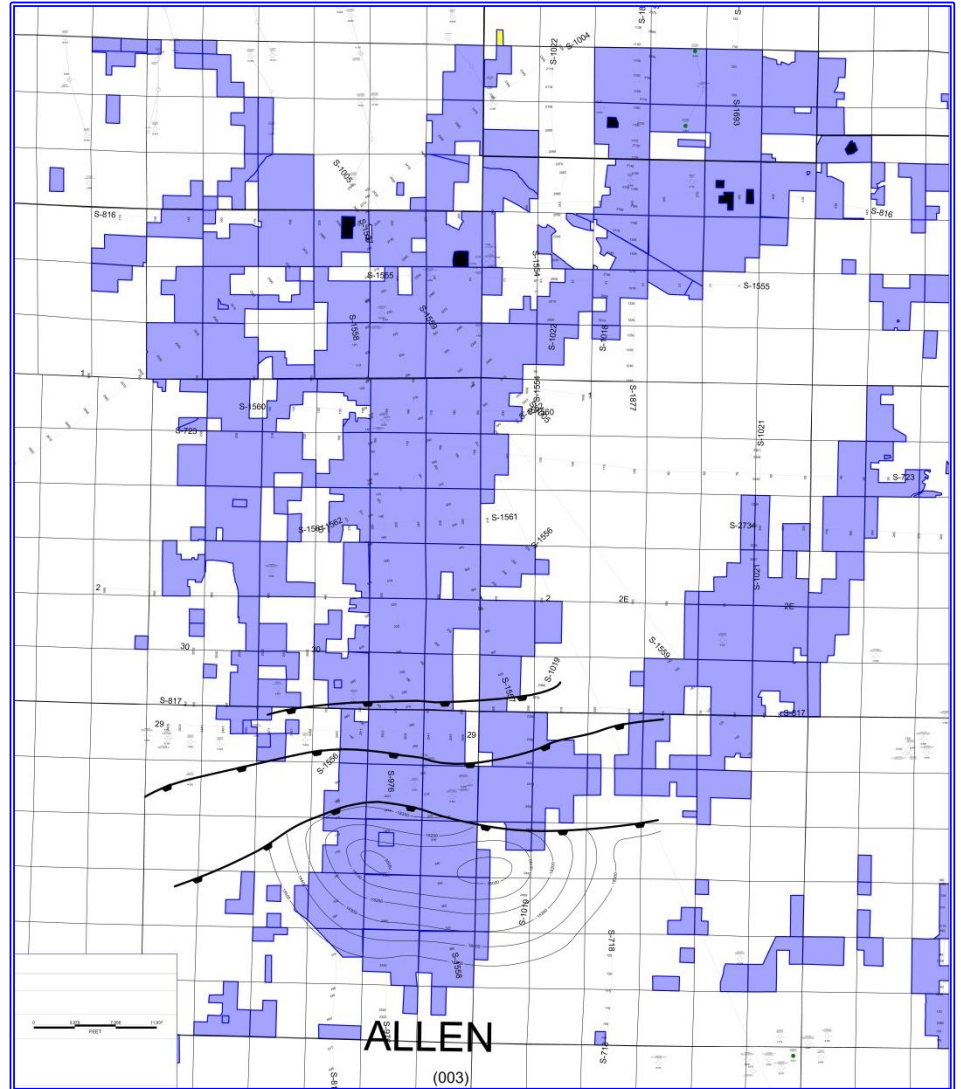

*3D seismic project proposed*

LaBokay Natural Resources holds mineral rights on ~270,000 acres in Western Louisiana. Our mineral assets include large blocks of contiguous ownership, have a history of strong production and ongoing reserve replacement, and have significant remaining potential. We offer mutually beneficial leases to energy exploration companies, and are highly responsive and efficient lease administrators. We will work collaboratively and creatively with production companies and prospect generators to realize the full potential of our oil and gas assets.

LaBokay Natural Resources ~ 1880 S Dairy Ashford Road, Suite 200 ~ Houston, TX 77077  
Paree Prejean, Business Manager ~ 713.783.1887 ~ [leasing@labokay.com](mailto:leasing@labokay.com)

**LABOKAY**  
Natural Resources

[www.labokay.com](http://www.labokay.com)

This information is not intended to be and should not be interpreted to be an exclusive offer. LaBokay reserves the right to reject any and all offers and to end discussions at any time without liability or obligation of any kind whatsoever.